

Кладочный и маркировочный план-9-го этажа М 1:100

23, 27, 31, 35
74.8
35.4
36.4
3.0

47, 51, 55, 59
74.8
35.4
36.4
3.0

22, 26, 30, 34
77.3
48.4
26.3
2.6

48, 52, 56, 60
77.3
48.4
26.3
2.6

21, 25, 29, 33
72.8
35.6
34.6
2.6

49, 53, 57, 61
72.8
35.6
34.6
2.6

24, 28, 32, 36
60.0
20.2
37.2
2.6

46, 50, 54, 58
60.0
20.2
37.2
2.6

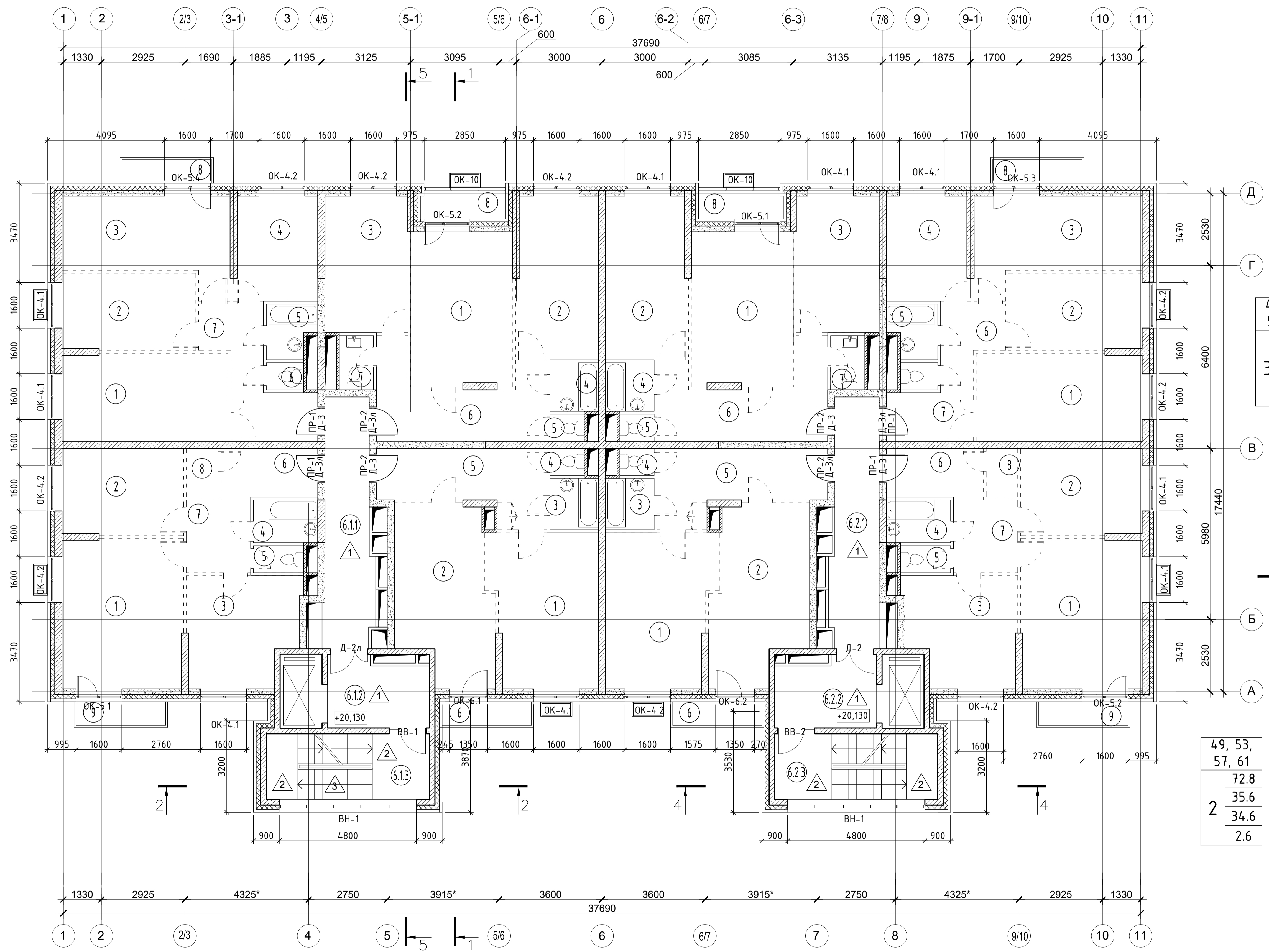

Architectural floor plan of the 9th floor showing brickwork and marking. The plan includes a grid of axes (1-11 horizontally, A-D vertically) and various rooms and structural elements. Dimensions are provided for grid spacing and room sizes. Key features include staircases (BB-1, BB-2), elevators (Д-2, Д-3), and various wall and window openings labeled with codes like ОК-4.1, ОК-5.1, etc. Section lines 1-5 and 1-4 are indicated with arrows.